

Heaton Green, Leigh, WN7 2EY  
£1,150 PCM





BALMER & CO are delighted to offer TO RENT this modern three bedroom mid terraced property, available for immediate occupancy. Ground floor accommodation comprises in brief, entrance hallway with downstairs cloakroom/W.C, living room, and fitted kitchen dining room with French doors opening to the rear gardens. To the first floor are three well proportioned bedrooms, master with en-suite shower room, and further family bathroom. Outside are landscaped rear gardens, with double driveway to the front providing off road parking.

Floor Plan

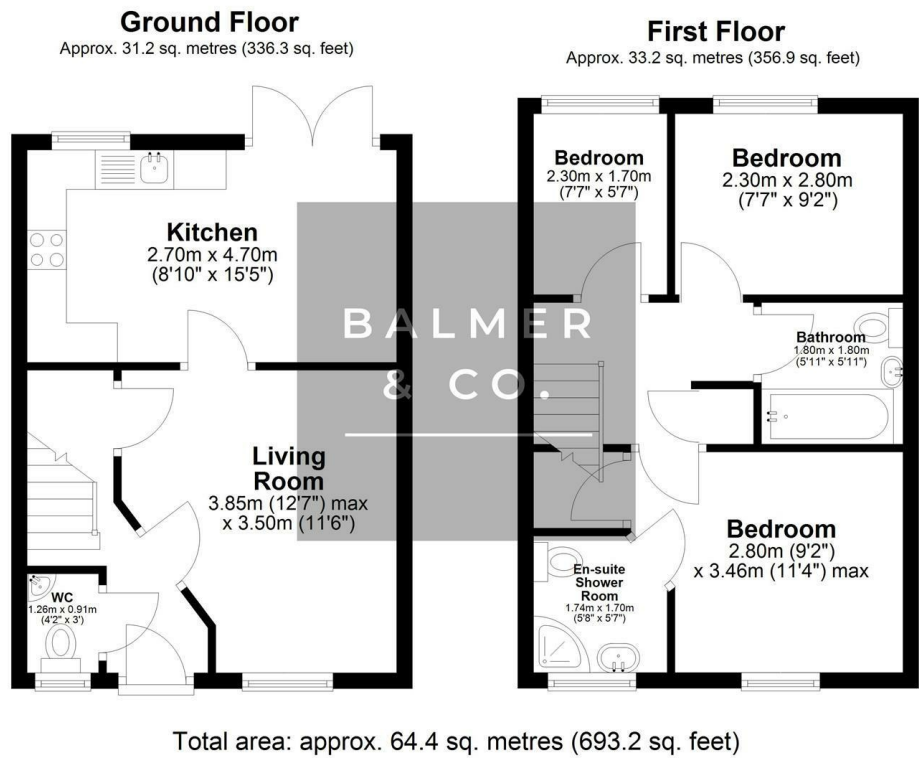

Area Map



Energy Efficiency Graph

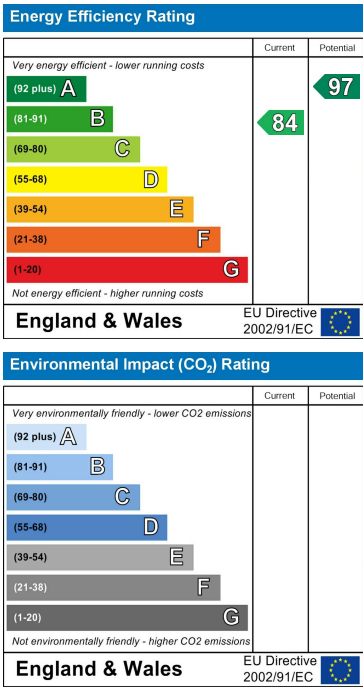

These particulars, whilst believed to be accurate are set out as a general outline only for guidance and do not constitute any part of an offer or contract. Intending purchasers should not rely on them as statements of representation of fact, but must satisfy themselves by inspection or otherwise as to their accuracy. No person in this firms employment has the authority to make or give any representation or warranty in respect of the property.